

# Battery BOX Quick Installation Manual

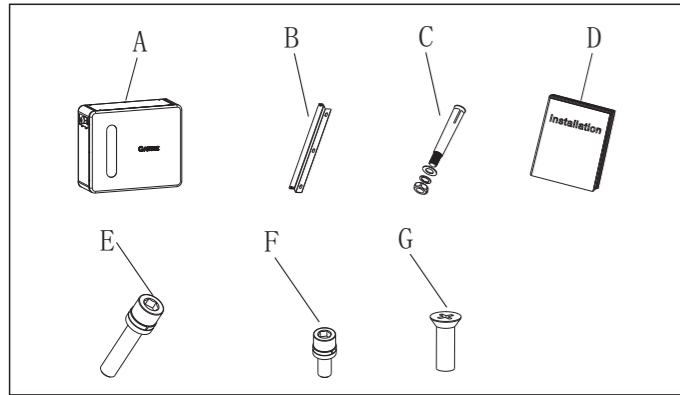

## 1. Checking

1. Open the packing box and take out all the accessory;
2. Check the battery box and check the quantity of all accessory according to the accessory list.



Serial number	number	name
A	1	Battery Box
B	1	Hanging bracket
C	3	Explosive bolt M10
D	1	Quick installation manual of Battery Box
E	2	Hexagon socket bolt M6X28
F	11	Battery set screw and ground screw (M6X12 three-in-one socket screw)
G	4	M4*12 large countersunk head cross screws

## 2. Hanging installation

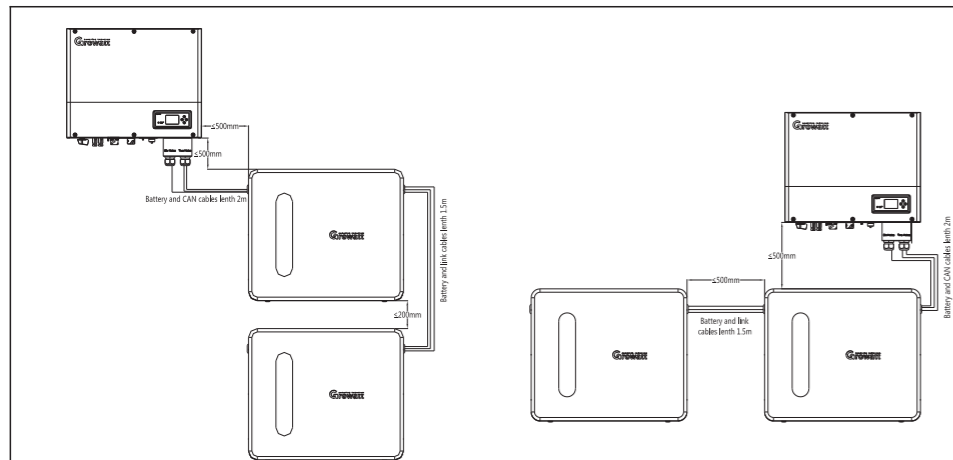

Figure 1. two battery packs in vertical parallel

Figure 2. two battery packs in horizontal parallel

1. Adjust the clearance between single or multiple battery boxes as shown in the picture below.
2. Then ,single/multiple battery box wall hangers are installed on the wall Figure 1 shows two battery packs in vertical parallel and figure 2 shows two battery packs in horizontal parallel.
3. After making sure the wall hanger is installed reliably, hang the battery box on the wall hanger and tighten the safety screws.

### Installation procedure

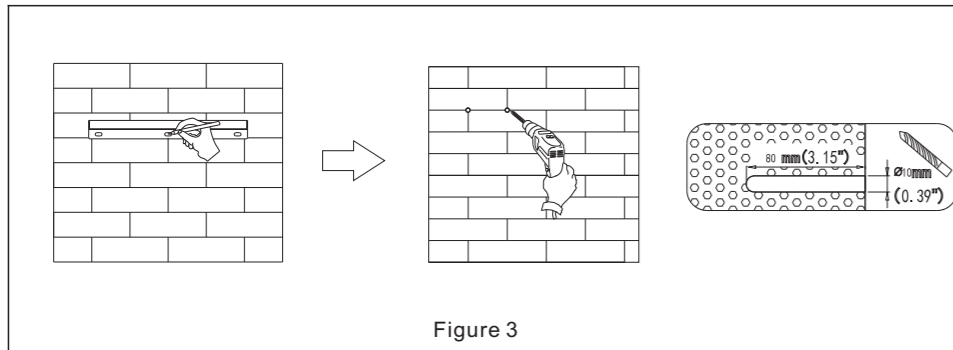

Figure 3

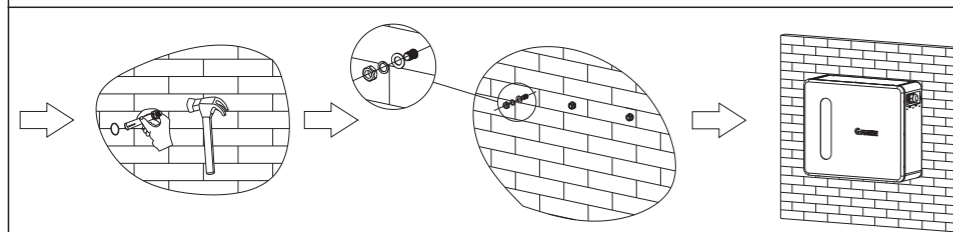

Figure 4

1. Please make sure that the thickness of the wall for inverter installations more than 120mm;
2. Please place the bitmap horizontally on the wall and confirm the level by level;
3. Please mark the holes in the 3 mounting holes of the pattern;
4. Drill a hole with a depth of 80mm at the mark with a drill of  $\phi 10$ mm

5. Please expand the bolt with a hammer into the hole in the wall and install the nut including elastic flat pad;
6. Please hang the inverter on the expansion bolt and tighten the nuts with a wrench.

## 3. Case disassembly and battery installation

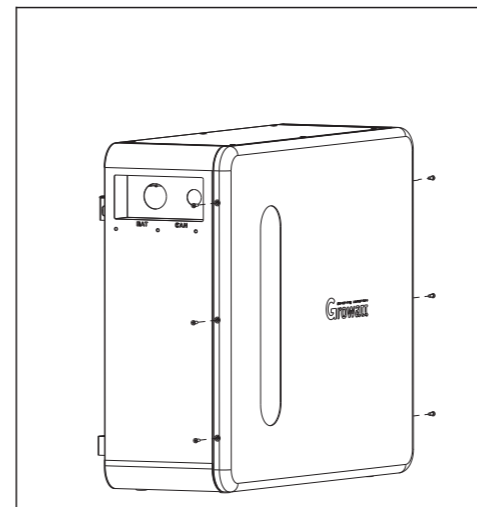

Figure 5 .(remove screws on left and right sides)

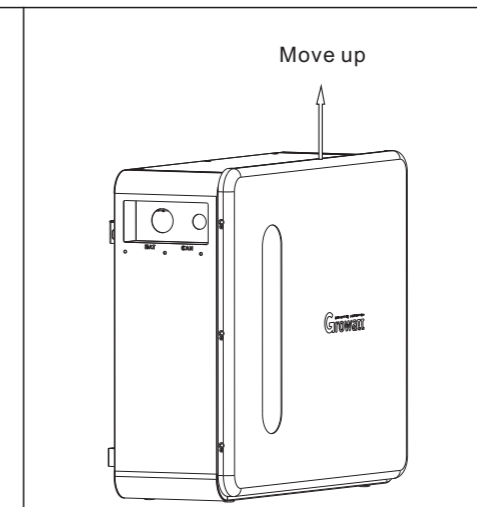

Figure 6. (push up the front panel)

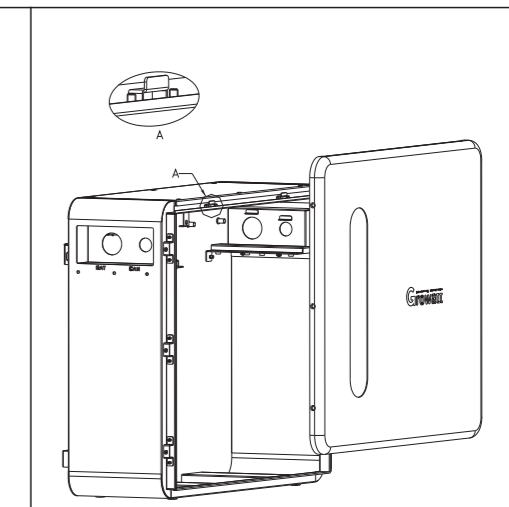

Figure 7 .(I-shaped bracket)

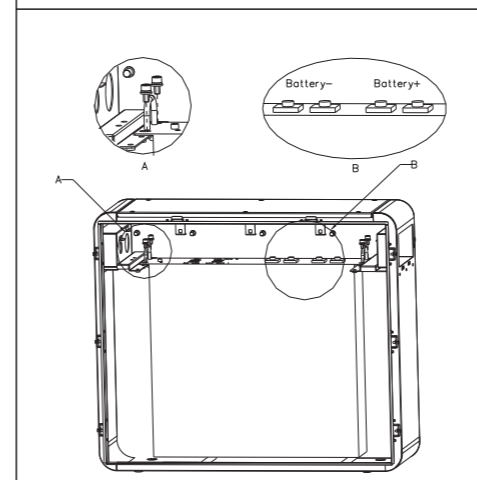

Figure 8. (battery installation and placement)

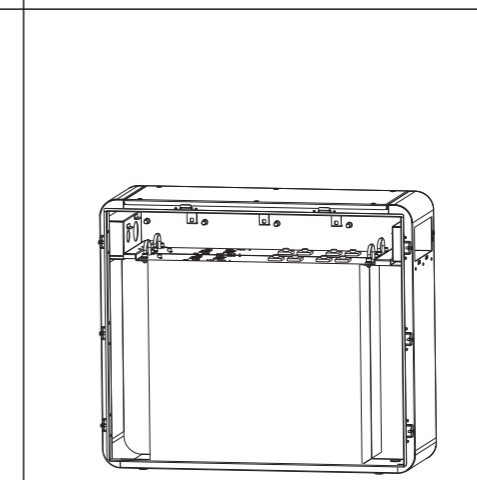

Figure 9.(position of two groups of batteries after installation)

1. Use a phillips screwdriver to loosen the six phillips countersunk screws on the left and right sides of the case (as shown in Figure 5). Move the front panel up and away from the front panel (as shown in Figure 6) to avoid the I-shaped drop bracket on the upper part of the case from hanging (as shown in Figure 7).
2. Place the lithium iron phosphate battery as shown in the figure (note the placement direction of the battery: the battery power terminal is on the right side of the chassis), tighten it with 4 M6\*12 hexagonal combination bolts (as shown in Figure 8), and fix the other battery in this way (as shown in Figure 9).

## 4. Electrical wiring

### 4.1 Inverter battery power line connection

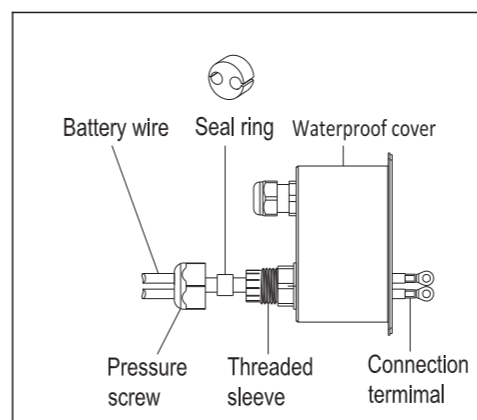

Figure 10

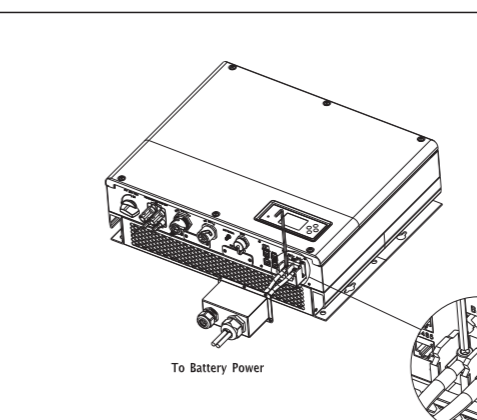

Figure 11

1. Pass the power line of the red-black battery through the fastening nut, waterproof rubber plug and waterproof cover successively.
2. Connect the battery wire to the BAT end of the machine, and pay attention to correct polarity. When installing the energy storage machine, do not connect it to the battery end first, to prevent the battery from starting up by mistake and operating with power on
3. Note: do not tighten the nut at this time. Tighten it together after all communication lines are installed.

## 4.2 Battery cable connection

### Note:

The battery is not allowed to be installed in the startup state, and all the battery RUN lights are off before installation.

1. Pass the CAN signal wire through the fastening nut, waterproof rubber plug and waterproof cover (as shown in Figure 12), connect one end to the battery (as shown in Figure 14 and Figure 15 CAN), and connect the other end to the energy storage machine;
2. Pass the power lines of the red-black battery through the fastening nut, waterproof rubber plug and waterproof cover successively (as shown in Figure 13), connect the internal battery cables in parallel (as shown in Figure 14), and connect the battery boxes in parallel (as shown in Figure 15);
3. After all the cables are connected, use the sealing plug to plug all the empty holes of the sealing rings and tighten the PG head of the waterproof fastener.

Note: after installation, check whether all holes of sealing ring are sealed with sealing plug.

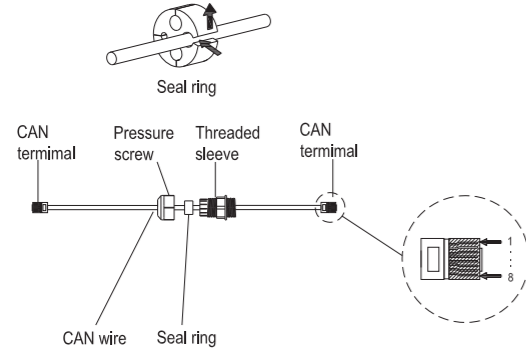

Figure 12. Pork wiring

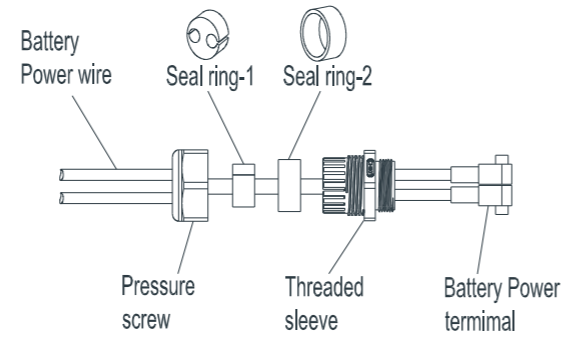

Figure 13 .Battery Power wiring

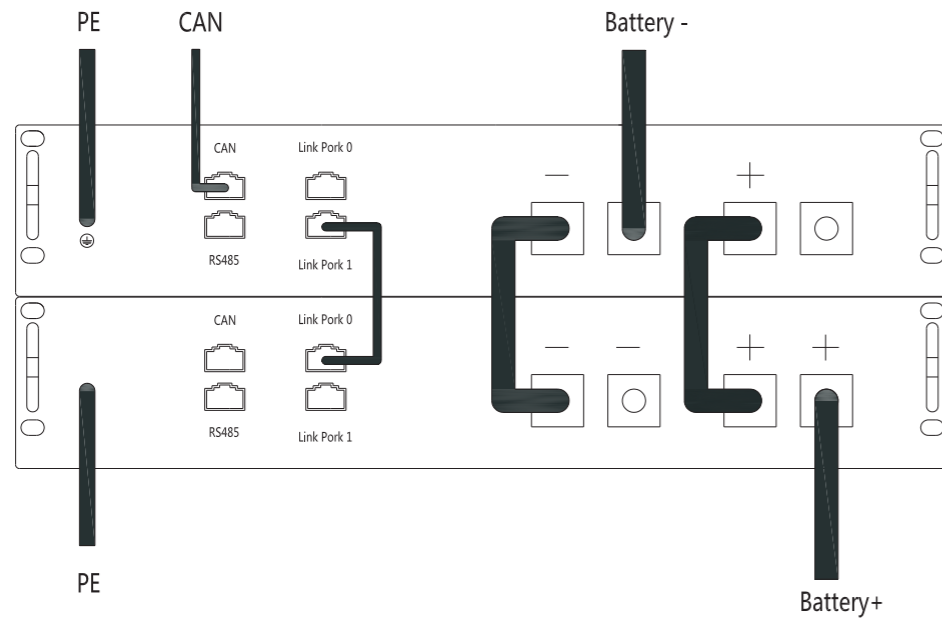

Figure 14 .parallel connection of two batteries

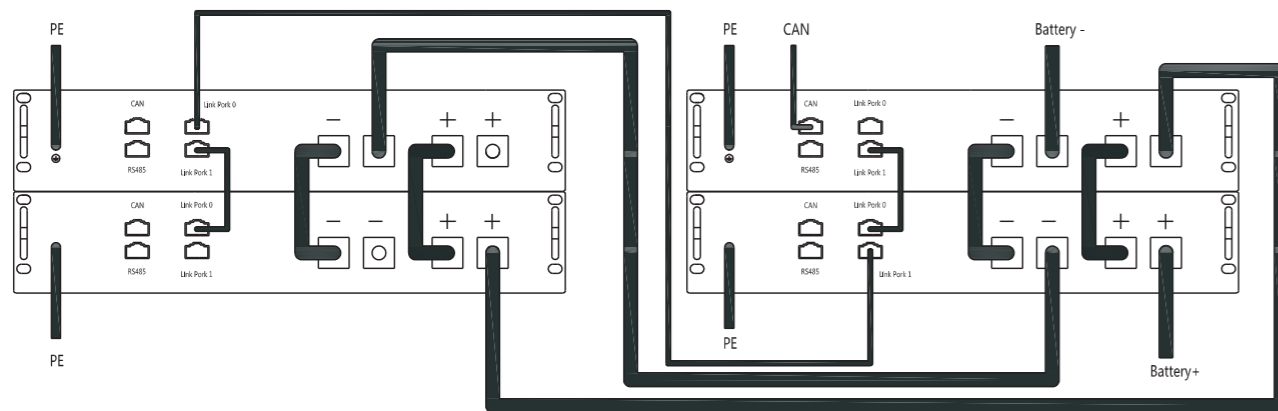

Figure 15. parallel connection of four batteries and two battery boxes

## 5. Box installation

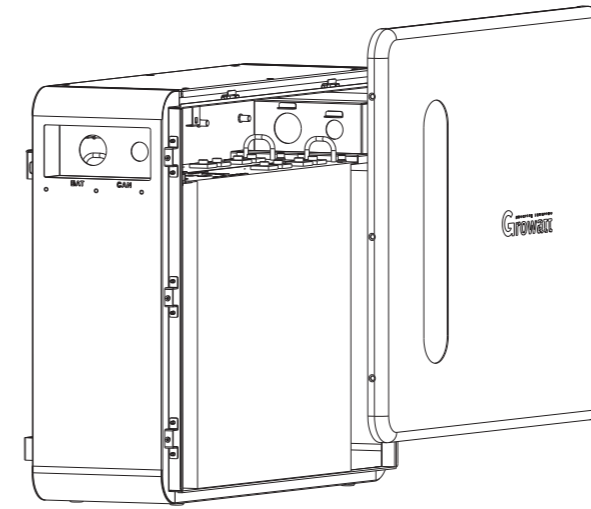

Figure16

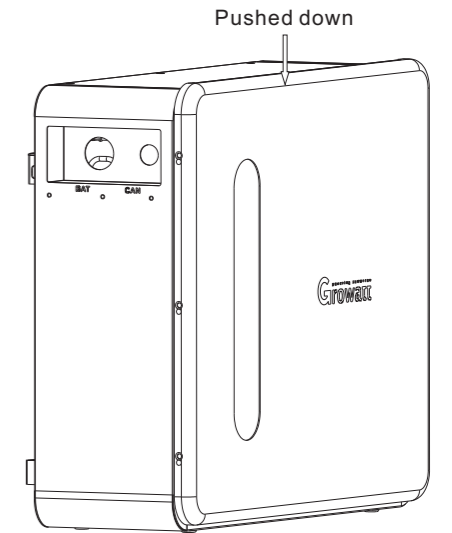

Figure17 (Pushed down the front panel)

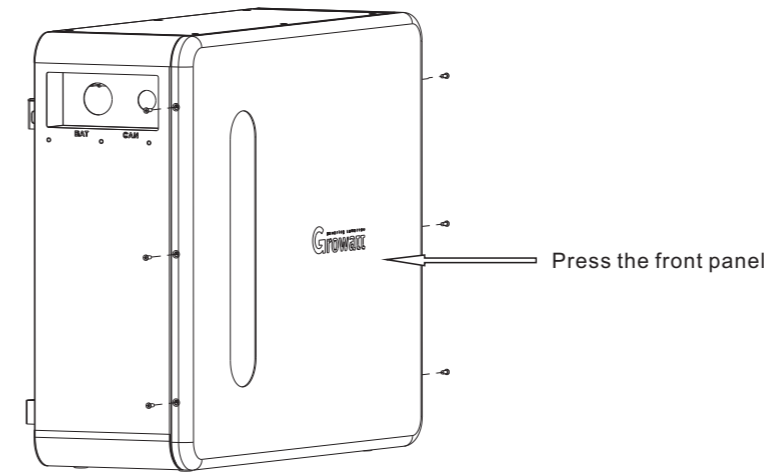

Figure18(Press the front panel)

### Note:

Before the front panel of the box is locked, the battery must be in the starting state. It is recommended to turn on all the battery power buttons first, and then press SW button when the parallel box of the last box is locked to avoid shutting down the box after sealing it!

1. Hang the front panel on the two I-shaped brackets at the upper end of the box (as shown in Figure 16). After hanging the front panel, push it down to avoid improper installation of the front panel (as shown in Figure 17).
2. Press and hold the front panel of the box body by hand to compress the sealing bar to ensure the matching of the hole position of the cross screws. Use the cross screwdriver to tighten the 6 M4 countersunk screws (as shown in Figure 18).
3. Lock all M4 countersunk head screws once to complete installation.



Download  
Manual



Growatt New Energy

Shenzhen Growatt New Energy Technology CO.,LTD  
No.28 Guangming Road, Shiyan Street, Bao'an District,  
Shenzhen, P.R.China

T +86 0755 2747 1942

E service@ginverter.com

W www.ginverter.com

GR-UM-154-A-00